



20 Barton Drive Horsham VIC

3 2 4

Set in the popular and well established Federation Estate is this brick veneer family home. The master bedroom features ensuite and walk in robe, while the remaining two bedrooms have built in robes. The open plan living area boasts plenty of space for the family with the kitchen offering stainless steel appliances, loads of cupboards and bench space and tiled flooring. There is a second living area, separate study and neat family bathroom. Outside is an extensive undercover area, established gardens and a fernery. There is a double garage and side access for a boat or caravan that leads to a large powered shed.

Price : \$ 403,000

View : <https://www.wdre.com.au/6517744>



Robert Dolan
0419440617



WES DAVIDSON
REAL ESTATE

20 BARTON DRIVE
HORSHAM

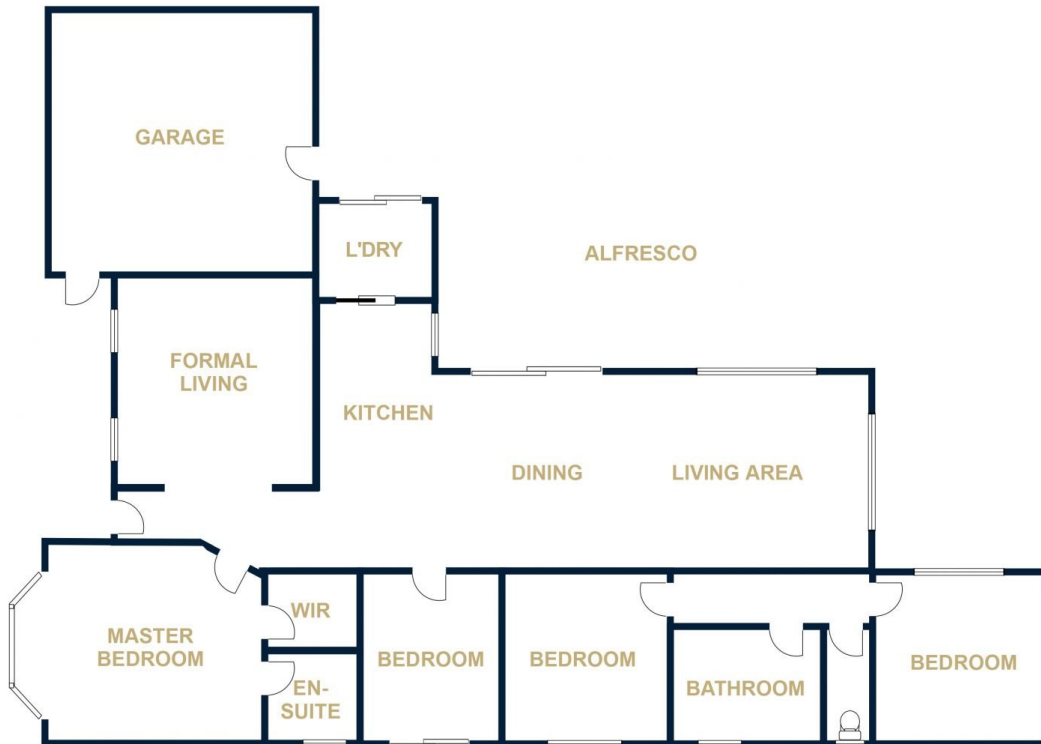

FLOOR PLANS/SITE PLANS ARE INTENDED AS A GENERAL GUIDE ONLY. NO REPRESENTATIONS OR WARRANTIES OF ANY NATURE WHATSOEVER ARE GIVEN OR INTENDED AND ANY PERSON USING THIS INFORMATION SHOULD ALWAYS RELY ON THEIR OWN ENQUIRIES.