



90-92 Firebrace Street Horsham VIC

Do not miss this opportunity to secure the perfect main street location for your business.

- *Large light filled reception area/ waiting room
- * Four consulting rooms plus an additional office and storage spaces
- * Ducted heating and cooling and an additional two split systems
- * Kitchenette and toilet at the rear of the building
- * Private car parking at the rear of the property
- * \$80,000 plus GST per annum plus all outgoings
- * Zoning: Commercial 1 Zone (CZ1)
- * Land size 294m2 Building size 215m2 (Approx per Corelogic)

Price : \$80,000 per annum (plus GST)
Building Size : 215 sqm
Land Size : 294 sqm
View : <https://www.wdre.com.au/7710894>



Robert Dolan
0419440617

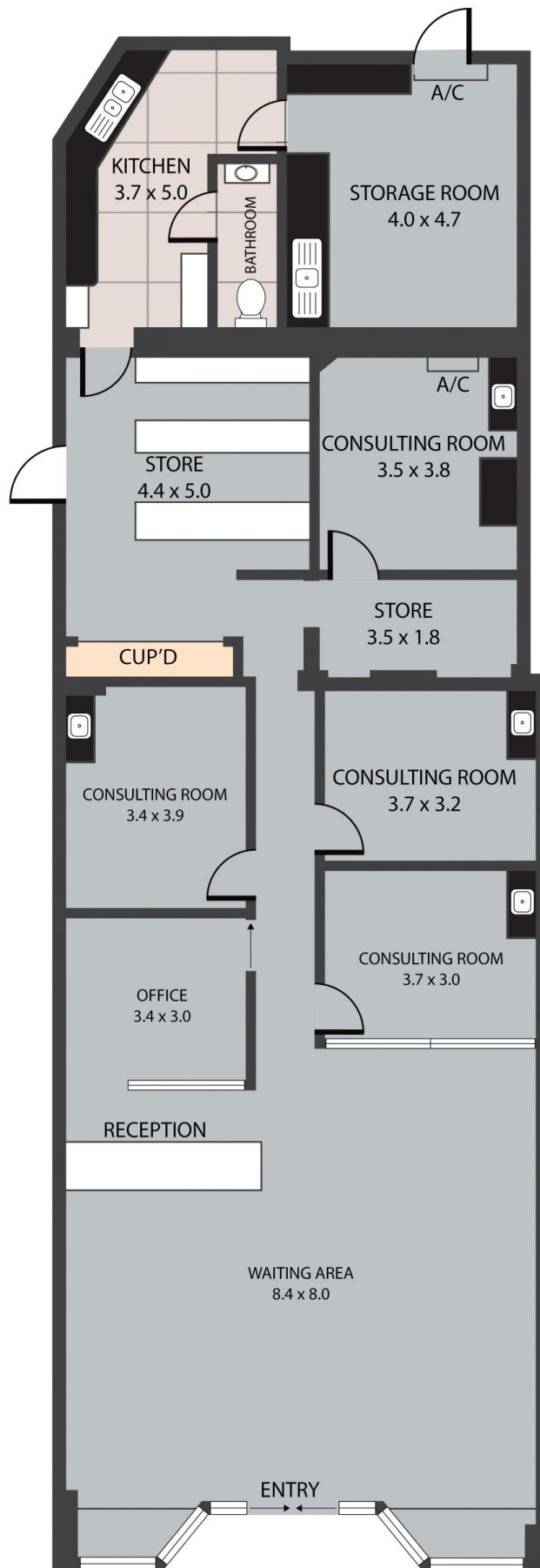

90/92 Firebrace Street, Horsham 3400

TOTAL APPROX. FLOOR AREA 215 SQ.M

Whilst every attempt has been made to ensure the accuracy of the floor plan contained here, measurements of doors, windows, rooms and any other items are approximate and no responsibility is taken for any error, omission, or misstatement. This plan is for illustrative purposes only and should be used as such by any prospective purchaser.